

Cape Cod Washbowl # 232848..00

| < ø 480 mm > |

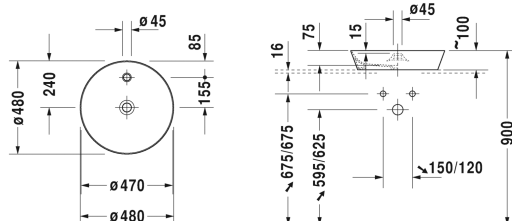

Washbowl	Dimension	Weight	Order number
with tap dome, without overflow, ø 480 mm			
Colors			
00 White Alpin 26 White/White Satin Matt 32 White Satin Matt			
Variant			
● inside colour White, outside colour White	ø 480 mm	6.100 kilogram	232848..00
Infobox			
Made from DuraCeram, Duravit recommends the following faucets for #232848: Duravit C.1 - M #C11020002, Grohe Essence New #32898001, Eurodisc Cosmopolitan #23448002, Concetto #23450001, Eurodisc Joy #23427000, Hansgrohe Metris 110 #31080000, Metris 200 #31183000, Talis 150 #32052000 and Axor Starck 10003000			
Sanitary ceramics with the special WonderGliss surface finish will remain clean and attractive-looking for a long time to come. When ordering WonderGliss please add a "1" as eleventh digit to the model number.			
Accessory			
Slotted waste for washbasins without overflow	50 mm	0.300 kilogram	005024
Design Siphon		1.500 kilogram	005036
Suitable products			
Vanity unit floor-standing 1 console, 1 Furniture with doors and shelf elements laterally, 1120 x 570 mm	1120 x 570 mm		CC9533
Vanity unit floor-standing 1 console, 1 shelf below, 1120 x 570 mm	1120 x 570 mm		CC9532
Vanit unit for console wall-mounted 1 pull-out compartment, 800 x 548 mm	800 x 548 mm		XS4900
Vanit unit for console wall-mounted 1 pull-out compartment, 1000 x 548 mm	1000 x 548 mm		XS4901
Vanit unit for console wall-mounted 1 pull-out compartment, 1200 x 548 mm	1200 x 548 mm		XS4902

Cape Cod Washbowl # 232848..00

| < ø 480 mm > |

Vanit unit for console wall-mounted 2 drawers, upper drawer including cut-out for siphon and siphon cover, 800 x 548 mm	800 x 548 mm	XS4910
Vanit unit for console wall-mounted 2 drawers, upper drawer including cut-out for siphon and siphon cover, 1000 x 548 mm	1000 x 548 mm	XS4911
Vanit unit for console wall-mounted 2 drawers, upper drawer including cut-out for siphon and siphon cover, 1200 x 548 mm	1200 x 548 mm	XS4912
Vanit unit for console floor-standing 2 pull-out compartments, integrated base frame legs with height adjustment, 800 x 548 mm	800 x 548 mm	XS4920
Vanit unit for console floor-standing 2 pull-out compartments, integrated base frame legs with height adjustment, 1000 x 548 mm	1000 x 548 mm	XS4921
Vanit unit for console floor-standing 2 pull-out compartments, integrated base frame legs with height adjustment, 1200 x 548 mm	1200 x 548 mm	XS4922
Vanit unit for console wall-mounted 2 pull-out compartments, 1400 x 548 mm	1400 x 548 mm	XS4903 L/R
Vanit unit for console wall-mounted 2 pull-out compartments, 1600 x 548 mm	1600 x 548 mm	XS4904 R/L
Vanit unit for console wall-mounted 4 drawers, 1400 x 548 mm	1400 x 548 mm	XS4913 L/R
Vanit unit for console floor-standing 4 pull-out compartments, integrated base frame legs with height adjustment, 1400 x 548 mm	1400 x 548 mm	XS4923 R/L
Vanit unit for console floor-standing 4 pull-out compartments, integrated base frame legs with height adjustment, 1600 x 548 mm	1600 x 548 mm	XS4924 L/R
Vanit unit for console wall-mounted 2 pull-out compartments, 1400 x 548 mm	1400 x 548 mm	XS4906 B
Vanit unit for console wall-mounted 2 pull-out compartments, 1600 x 548 mm	1600 x 548 mm	XS4907 B
Vanit unit for console wall-mounted 4 drawers, upper drawer including cut-out for siphon and siphon cover, 1400 x 548 mm	1400 x 548 mm	XS4916 B
Vanit unit for console wall-mounted 4 drawers, upper drawer including cut-out for siphon and siphon cover, 1600 x 548 mm	1600 x 548 mm	XS4917 B
Vanit unit for console floor-standing 4 pull-out compartments, integrated base frame legs with height adjustment, 1400 x 548 mm	1400 x 548 mm	XS4926 B
Vanit unit for console floor-standing 4 pull-out compartments, integrated base frame legs with height adjustment, 1600 x 548 mm	1600 x 548 mm	XS4927 B

All drawings contain the necessary measurements which are subject to standard tolerances. They are stated in mm and are non-binding. Exact measurements, in particular for customised installation scenarios, can only be taken from the finished ceramic piece.